

# WIR-053-F PIR Motion Detector User Manual



## • Instruction

WIR-053-F PIR motion detector is a wireless passive infrared detector with high stability. It adopts advanced technology in signal processing and provides superhigh detection ability and anti fault alarm ability. The detector will detect movement of human automatically when intruder pass through the detected area, and it will send alarm signal to alarm host if there is movement. The product is designed suitable for the safety of residential house, villas, factories, markets, warehouses, office building etc. usage.

## • Product structure

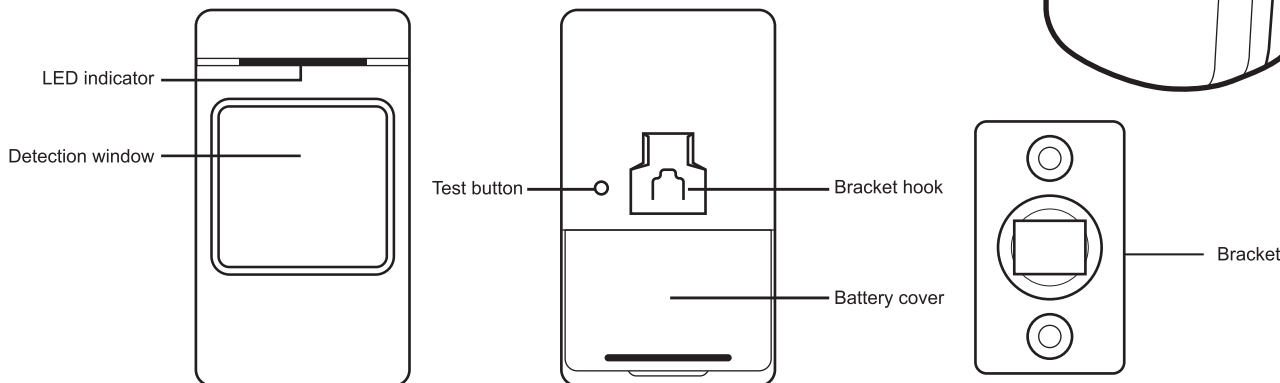

## • Inner structure

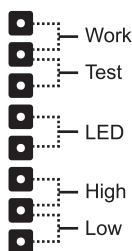
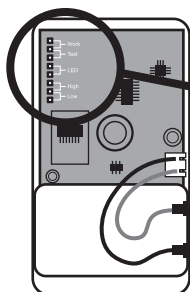

1. Work: means detector set in working mode, once the alarm is triggered, it could not be triggered again until 5 minutes later. This can make PIR longer battery life.
2. Test: means detector set in test mode, it will trigger immediately once detect motion, do not need to wait 5 minutes. This will cause shorter battery life.
3. LED: when the jumper plugged, LED will turn on when detector trigger, remove the jumper will set LED always off. When normal battery level, LED light in blue color, when low battery, the LED will light in red color.
4. High: means higher sensitivity, the detect range will be near 8 meters.
5. Low: means lower sensitivity, the detect range will be near 5 meters.

## • Pair with alarm host

WIR-053-F PIR detector need to work with alarm host, it need to pair PIR with alarm host when first time use. The pairing method as following:

1. Install 2pcs AA size battery on PIR detector, it will power on when battery installed.
2. Make alarm host enter sensor pairing mode, press the "Test" button on PIR to trigger wireless signal.
3. Alarm host will store the PIR code and pair PIR success.

PIR default set in working mode, need to wait 5 minutes for new trigger alarm. To make PIR trigger for every motion, make jumper work in TEST mode.

When PIR low battery, LED will light in red when trigger, it will send different alarm signal when trigger in low battery. Alarm host will recognize the low battery information and notify users by SMS or message on APP.

## • Installation

After paired with Main unit, choose a suitable installation location:

Recommend to mount it at height of 2M from ground. Install the detector vertical direction of entrance, human walk cross the detector cover area; no allow installing detector horizontal of human walking direction.

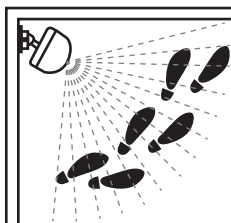

Fixed the bracket on wall with screws and attached the detector to the bracket.

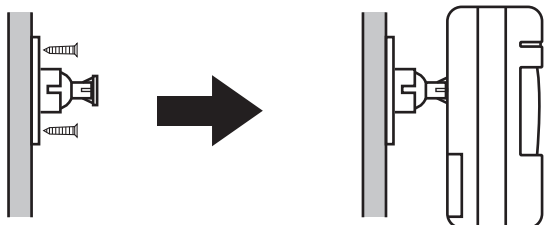

## • Technical specification

Radio Frequency	FSK 433.92
Detector dimension: (L×W×H)	106×60×44mm
Bracket dimension: (L×W×H)	52×28×28mm
Detection range	8 meters or 5 meters
Detect angle	80°
Operation condition	temperature -10 to 50°C
Relative humidity	≤80%
Standby current	≤60uA
Working current	≤2mA