

WIS-055-F Wireless Siren Manual

Power on Siren

Plug the power adaptor to 220V power socket, connect power cable with siren cable connector, siren LED will light in Green color when power on.

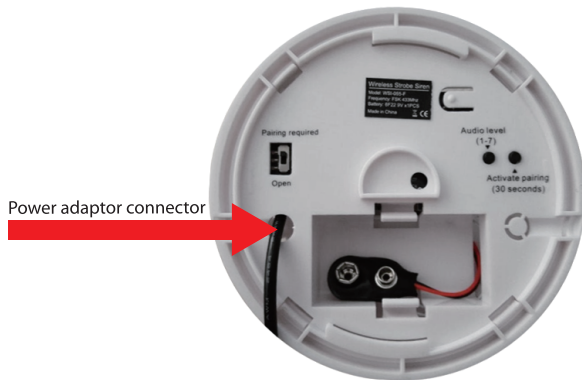

There are two working mode: Open and Pairing required, when switch to "Open" mode, it do not need to pairing Siren with Main Unit, any Main Unit alarm code can trigger the siren, any WRC-047-F remote control can stop the siren. When switch to "Pairing required" mode, it need to pairing siren with Main Unit, siren only working with paired Main Unit code.

"Open" mode:

put the switch to "Open" direction, siren will working in "Open" mode, put the siren near Main Unit (Within 20 meters range), when Main Unit alarm, it will trigger siren, siren will sound immediately. First 10 seconds will sound in low volume, after 10 seconds it will sound as setting volume. Siren will auto stop after 90 seconds sound. User can stop the siren by pressing WRC-047-F remote control Disarm button.

"Pairing required" mode::

At "Pairing requested" mode, need to working with WRC-047-F Remote control, firstly paired remote control with siren, second step is pair Remote control with Main Unit, after that pair Main Unit with siren.

- Pair WRC-047-F remote control with siren
Short press "Pairing" button of WSI-055-F siren. Siren green LED will OFF, it means siren in pairing status.
Press SOS button of remote control, when siren received the code, green LED will on and flash, then paired remote control with siren success.
- Pair WRC-047-F remote control with Main Unit.
Pair remote control with Main Unit by SMS command or setting button, read the Main Unit manual for more details.
- Pair Main Unit with siren:
Short press "Pairing" button of WSI-055-F siren. Siren green LED will OFF, it means siren in pairing status.
Press SOS button on remote control, Main Unit will emergency alarm and transmit code to siren, when siren received the code, green LED will on and flash, then paired Main Unit with siren success.

Deleted pairing:

Keep pressing the "Activated parring" button for 10 seconds, it will delete paired Main Unit and remote control code.

Volume adjust:

Siren max 110dB, You can pressing "Audio level" button to adjust the volume, total 7 levels of volume, keep pressing the "Audio level" button, it can select different volume cyclically.

Working as wireless sensor repeater:

WSI-055-F working as wireless sensor repeater, it will auto forwarder wireless signal from Remote control, Door magnetic, Smoke detector, PIR detector, it can make wireless sensor working longer distance.