

ME201W Wireless level sensor

Manual V2.1

1. Definition



Wifi: Between sensor and router(max 50m no obstacle)

Touch Key (☺): Press 5 seconds for WiFi connection

Network mode: 2.4G WiFi

LED: WiFi status

WiFi Config: Led light flashes rapidly

WiFi Connected: Led light on

WiFi Not Connected: Led light off slowly

Adaptor: AC 110V~240V

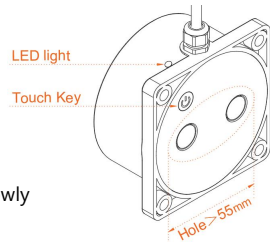

Sensor power supply: ≤100mA@ 5V DC

Level Range: 0.1m~4m

Accuracy: ± 0.02m

Operation Temperature: -20℃~70℃

Protection: IP65

2. Connection

1. Power on the AC/DC ADAPTOR first, and then power on the sensor, the sensor's led light flashes.
2. Scan code to download "TUYA Smart APP" or "Smart Life APP" on mobile device.



3. Network Reset

Press and hold the button (☺) for 5s, the led light flashes rapidly, then release the button, the network reset, the device connect to the network automatically.

4. Connecting Sensors to APP

Turn on the WiFi and Bluetooth of your phone, enter the app and add device.

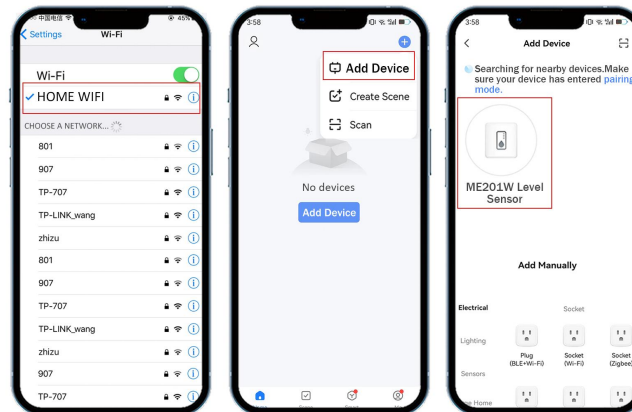

01-Turn on mobile WiFi & Bluetooth

02-Add device

03-Connect Level Sensor

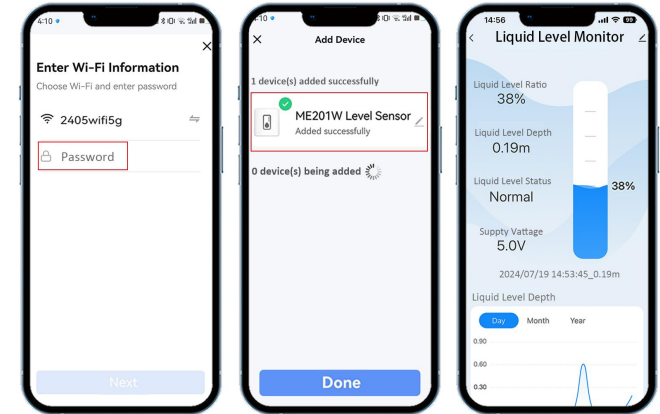

04-Enter WiFi password

05-Click on the Level Sensor

06-Enter the liquid level interface

*Note:

1. WiFi frequency can only be 2.4GHz, not 5GHz;
2. When adding a device, make sure that the sensor and the phone are connected to the same WiFi. After the setting is complete, the indicator must work under steady light. If the phone cannot find the device or fails to connect to the device, hold down the button for 5s until the indicator flashes to add the device again.

3. Setting

1. **Installation height:** Set the distance from sensor to tank bottom (A);
2. **Liquid maximum depth:** Maximum height of liquid in tank (B);
3. **Set Max:** Set Max for high level alarm (Actual liquid level value C);
4. **Set Min:** Set Min for low level alarm;

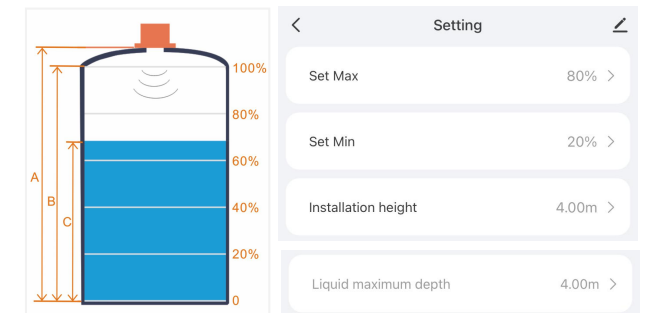

e.g.

Installation height, A=4m; Liquid maximum depth, B=3m;
 Actual liquid level value, C=2m; Set Max=60%, Set Min=20%,
 Level Status: **Full alarm** ($C/B*100\%=2/3*100\%=67\%$)

4. Installation

1. Remove the release paper from the gasket, and attach the gasket to the center of the tank where the hole will be drilled.
2. Drill a hole right in the middle of the tank with a diameter of >55mm;
3. Place the sensor over the gasket, Keeping it aligned with the screw holes. unobstructed;
4. Fasten the sensor with a self-tapping screw.

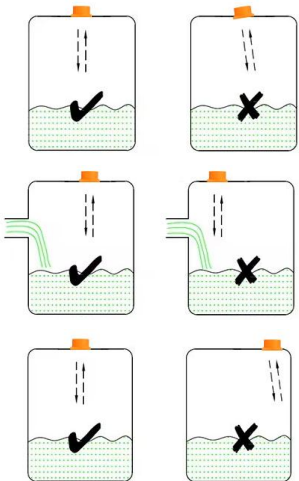
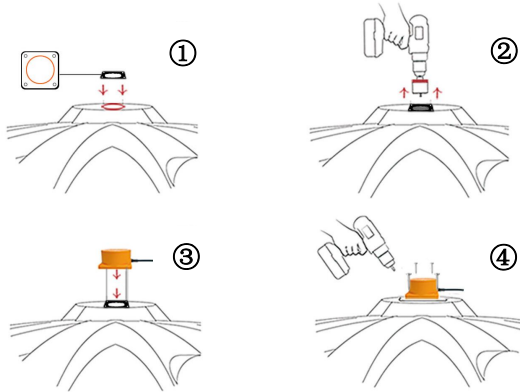

Hold the sensor perpendicular to the liquid

Install the sensor away from the water inlet to avoid pseudo-echo

The sensor installation cannot be close to the bulkhead, otherwise it will cause a strong pseudo-echo

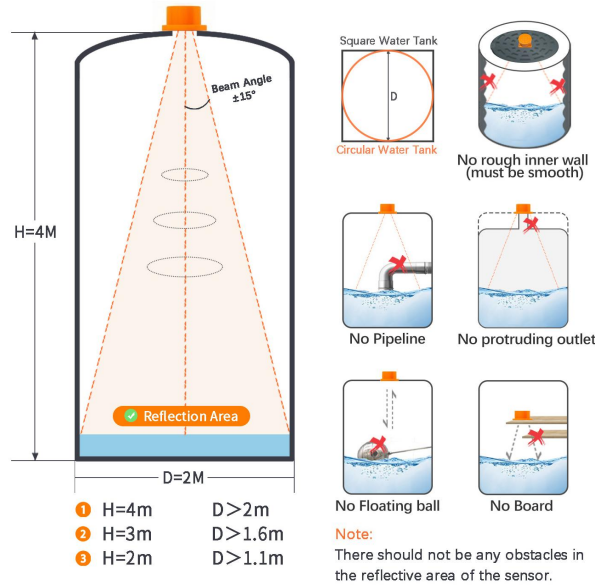

***Note:** If the mounting surface is curved, it is sufficient to fix the sensor with screws just, prevent the sensor from being stressed; when the data is abnormal, the screws must be loosened.

5. Level Status

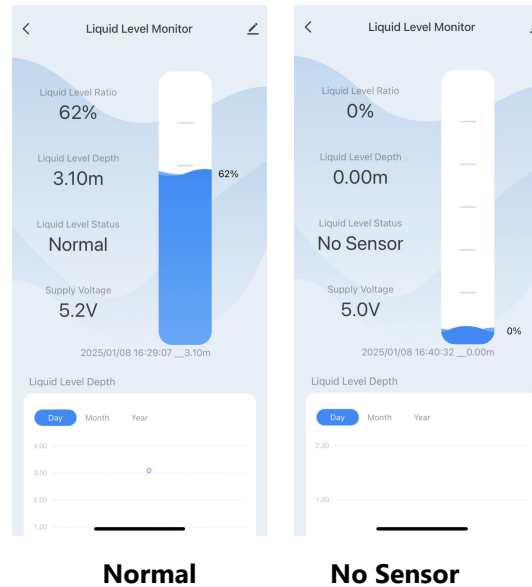

Normal

No Sensor

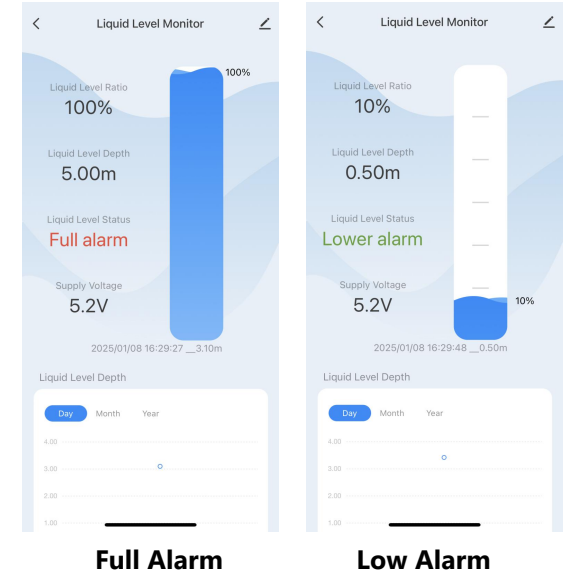

Full Alarm

Low Alarm

6. Share Device

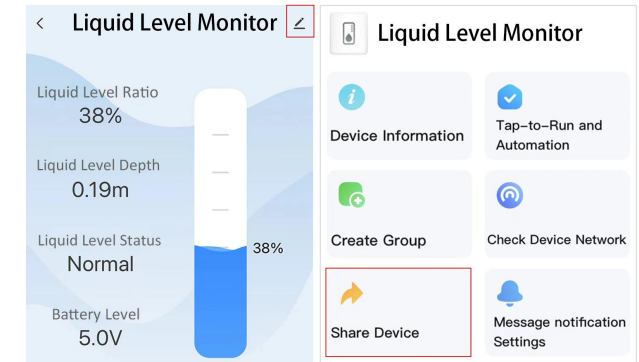

Can share water tank data with others.